

160/10-40

PROPOSED PLAN FOR
RESIDENTIAL COLONY
'SHALIMAR GARDEN'
VILLAGE CHACHOKI
TEH PHAGWARA
DISTT KAPURTHALA

PROMOTERS
WHITE ROSE ESTATE & INVESTMENT PVT
LTD.
G.T. ROAD, GORAYA
TEH. PHILLAUR, DISTT. JALANDHAR

SCHEME BOUNDARY
TOTAL AREA OF THE COLONY 17455 SQ YDS
= 361 ACRES OR 246 HECTARS
AREA UNDER RESIDENTIAL COLONY

SNO	PLOT NO	MOOFA	AREA IN SQ YDS	TOTAL IN ACRES
1	217, 9, 10	8	500	4000.00
2	1	1	578.55	578.55
3	12 & 20	9	452.5	4072.50
4	21 & 24	4	200	800.00
5	8, 11	2	511	1022.22
TOTAL SALEABLE AREA			10473.27	216.59%
AREA UNDER PUBLIC UTILITIES				
SCHOOL			1860.27	10.66%
HEALTH CENTRE			385.85	2.20%
WATER WORKS			180.00	1.03%
PARK			1070.83	6.14%
TOTAL			3597.35	20.61%

AREA UNDER ROAD 3547.5 0.23 20.61%
TOTAL 17455 3.61 100.00%
SALEABLE AREA AS % OF TOTAL AREA 59.99%
OPEN AREA AS % OF TOTAL AREA 40.01%

LAYOUT PLAN
SCALE - 1" = 40'-0"

OWNER <i>Sunil</i>	NORTH ↑
ARCHITECT <i>K. Chauhan</i>	
DATE - 27.02.2001	
DESIGN NO - PC/169/104	
DEPT BY - MANIKA	
CHECKED BY - RAJINDER	

DHAM CONSULTANTS
ARCHITECTS, PLANNERS
INTERIOR DESIGNERS & STRUCTURE
ENGINEERS
G17 Sec-16-D CHD
PH- 771525

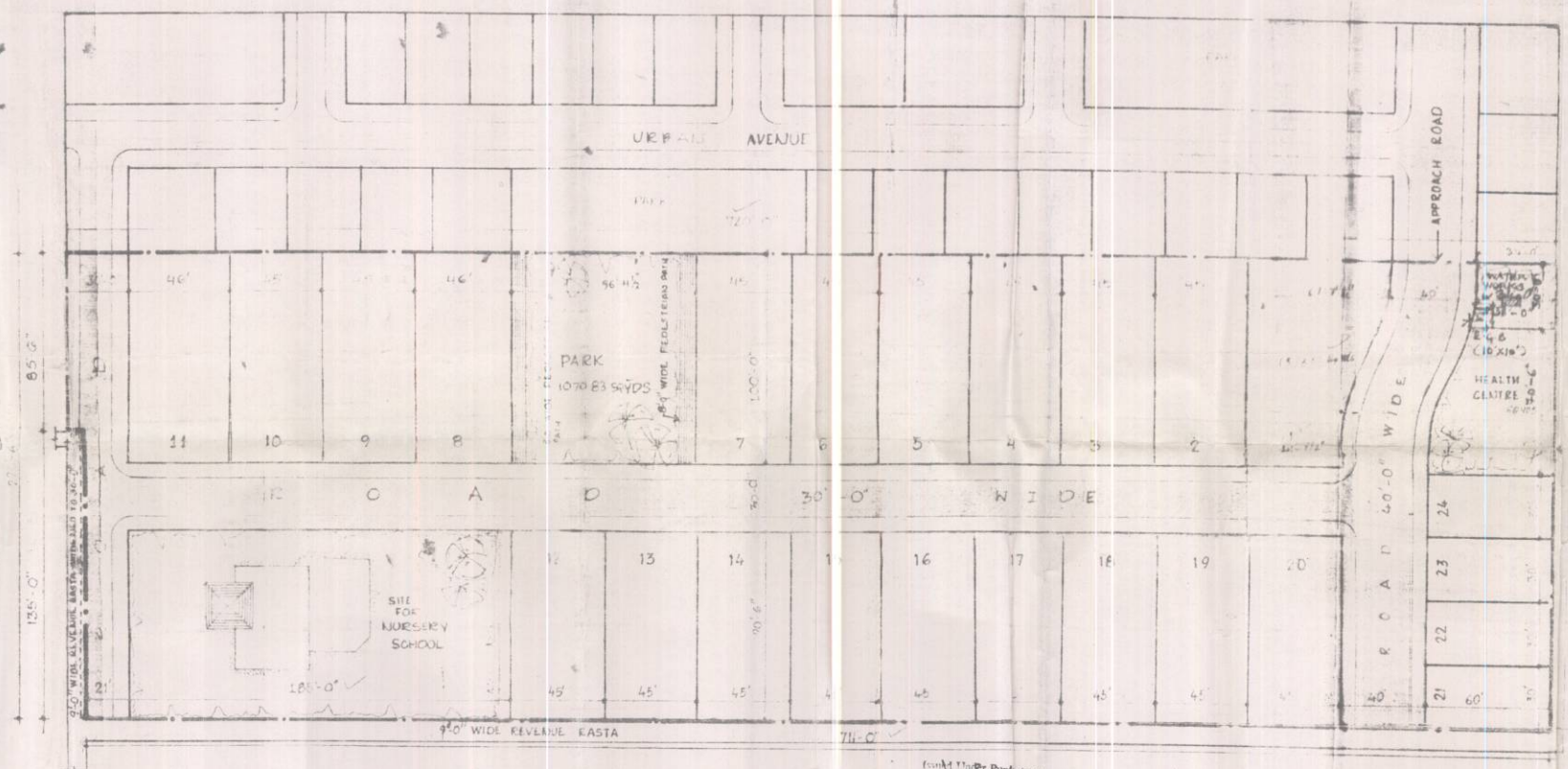

Issued Under Punjab Apartment & Property Regulation Act 1995 & Rules made thereunder
Licence No. 778 dated 28.04.2001
Valid upto 22.07.2007

Chief, Administrator
PUD, Kapurthala

Issued Under Punjab Apartment & Property Regulation Act 1995 And Rules made thereunder
Licence No. 778 dated 28.04.2001
Valid upto 22.07.2007

Competent Authority
Under PAct, 1995
S. Nigra

S. Nigra
Chief Town Planner
Dept. of Town & Country Planning
JALANDHAR

Sunil Mgt Director