

PROPOSED RESIDENTIAL COLONY PUNJABI BAGH  
 IN VILL. BHULATH WEST HB. NO-122 EAST HB:  
 NO-123 TEHSIL BHULATH.  
 DISTT. KAPURTHLA.

12

PROMOTER :-

SH. JASWINDER SINGH S/O SH. HARBHAJAN SINGH  
 R/O 504-1 SHERPUR MODEL COLONY CANTT ROAD,  
 MITTHAPUR, JALANDHAR.

TOTAL AREA OF COLONY : 19269.25 SQ. YDS (31.11-171M)  
 OR - 3.98 ACRE OR : 1.61 HACTARE

REFERENCE :-

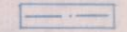
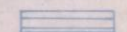
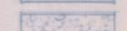
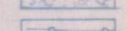
- COLONY BOUNDARY 
- ROAD 
- PARK & OPEN SPACE 
- ELECTRIC LINE / POLE 

SNO.	PLOT NO.	NOS	SIZE	AREA IN SQ. YDS.	
1	1	1	44'-6" x AS PER SITE	422.50	
2	2 TO 4	3	47'-6" x 90'-0"	1425.00	
3	5 TO 7	3	36'-6" x 90'-0"	1155.00	
4	8	1	37'-6" x AS PER SITE	417.50	
5	9	1	34'-0" x AS PER SITE	276.41	
6	10 TO 13	4	34'-0" x 70'-0"	1057.78	
7	14 TO 17	4	34'-0" x 60'-0"	906.67	
8	18	1	36'-0" x AS PER SITE	253.85	
9	19 & 19-A	2	42'-6" x 75'-0"	708.85	
10	20 TO 23	4	34'-0" x 68'-0"	1027.56	
11	24	1	44'-0" x AS PER SITE	306.00	
12	25	1	36'-0" x AS PER SITE	342.33	
13	26	1	36'-0" x AS PER SITE	300.00	
14	27	1	36'-0" x AS PER SITE	276.00	
15	28	1	36'-0" x AS PER SITE	252.00	
16	29	1	36'-0" x AS PER SITE	228.00	
17	30	1	36'-0" x 58'-0"	236.00	
18	31	1	40'-0" x AS PER SITE	291.16	
19	32 TO 36	5	35'-0" x 82'-0"	1503.33	
TOTAL NO. OF PLOTS - 37				TOTAL SALEABLE AREA = 11354.60	58.92%
AREA UNDER SEWERAGE TREATMENT PLANT				250.00	1.30%
AREA UNDER PARKS I & II				966.67	5.02%
AREA UNDER ROADS & OPEN SPACE				5459.28	28.32%
AREA UNDER WATER WORK				165.33	0.86%
AREA UNDER SCHOOL				1073.37	5.51%
				7914.65	41.07%

LAY-OUT PLAN



DRAWING NO:- PB(B-E&W)-4 SCALE USED = 1" = 40'-0"

DATED :- 20/10/2006

*Jaswinder Singh*  
 SIGNATURE OF PROMOTER

*AR. SANJAY KUMAR*  
 Bachelor of Architecture  
 Member, Council of Architecture (India)  
 Approved Architect-PUDA, Jalandhar  
 Reg. No. PUA-JAL-ACA-XXIV  
 SIGNATURE OF ARCH./TOWN PLANNER

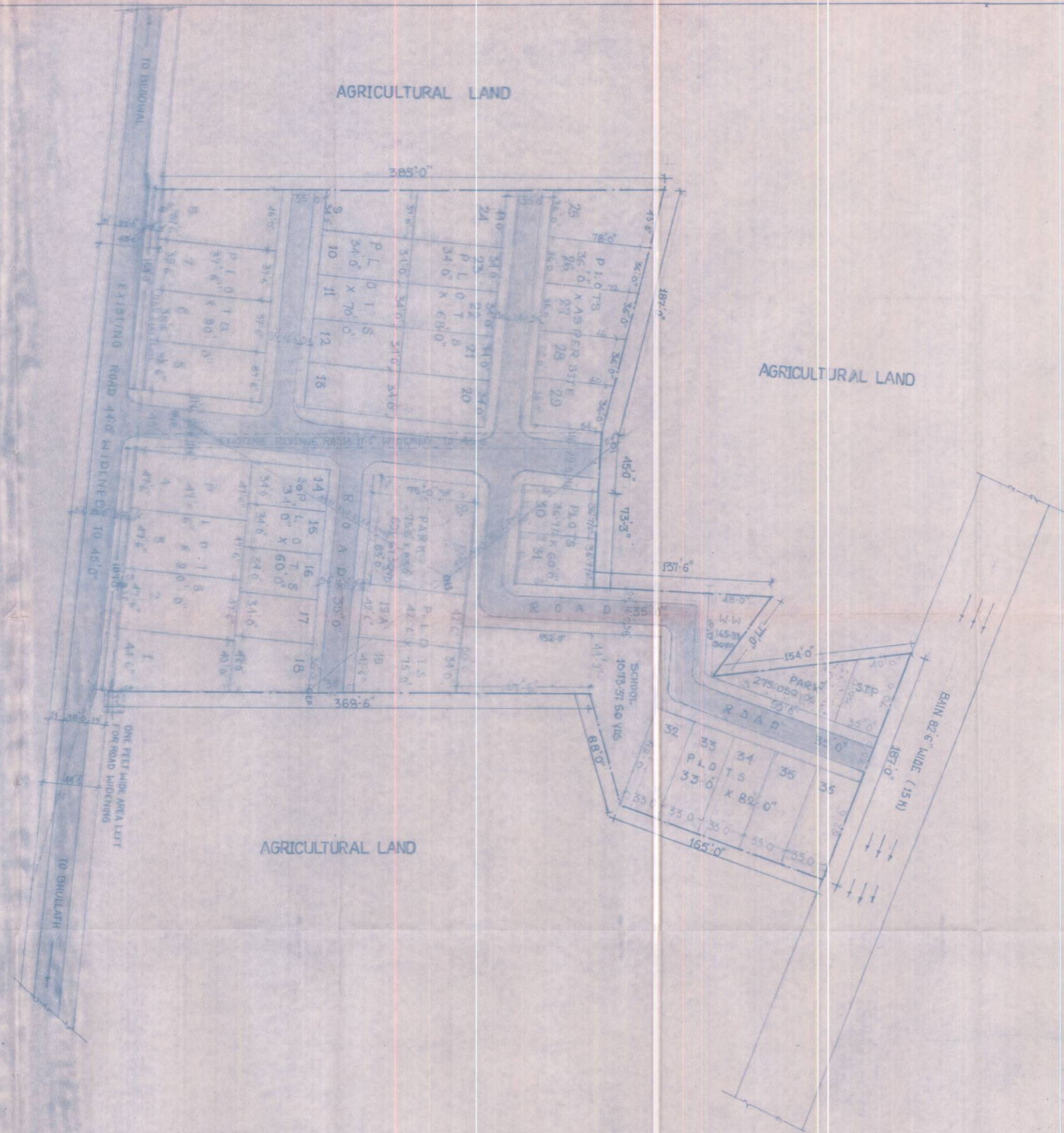

AGRICULTURAL LAND

AGRICULTURAL LAND

AGRICULTURAL LAND

AGRICULTURAL LAND