

**PROPOSED RESIDENTIAL COLONY 'PRIME AVENUE'
ON ADAMPUR - ALAWALPUR ROAD AT VILLAGE ADAMPUR
DISTT. JALANDHAR.**

LOT No. 481
STP (P.A.A)-39, Dt. 30-3-06

PROMOTER :-

PRIME PROPERTY BUILDERS & COLONISER.
THROUGH :- DALJIT SINGH SAHNI (PARTNER)
MAIN ROAD ADAMPUR, OPPOSITE SAGAR RESTAURANT, AT ADAMPUR, DISTT. JALANDHAR.

**TOTAL AREA OF COLONY = 18180.25 SQ.YDS.
OR = 3.76 ACRES OR = 1.52 HECTARES**

DETAIL OF RESIDENTIAL AREA

S.NO.	PLOT NO.	NO'S OF PLOT	SIZE OF PLOT	AREA IN SQ.YDS.
1	1 TO 9	9	35' X 60'	2100.00
2	10	1	37'-6" X 65'	270.83
3	11 TO 13	3	35' X 65'	758.33
4	14 & 18	2	36'-6" X 57'-6"	466.39
5	15 TO 17	3	30' X 57'-6"	575.00
6	19 & 23	2	36'-6" X 50'	405.56
7	20 TO 22	3	30' X 50'	500.00
8	24	1	40' X 27'-6"	122.22
9	25 & 35	2	35' X 69'-6"	540.55
10	26 TO 34	9	30' X 69'-6"	2085.00
11	36 TO 41	6	30' X 65'	1300.00
TOTAL	41			9123.88





COMMERCIAL (SHOPS)				
1	1 & 12	2	11'-3" X 30'	75.00
2	2 TO 11	10	10' X 30'	333.33
3	13 TO 18	6	10' X 30'	200.00
TOTAL	18			608.33

TOTAL SALEABLE AREA = 9732.21 53.53% AGE

AREA UNDER NURSERY SCHOOL = 983.33
 AREA UNDER WATER WORKS = 113.06
 AREA UNDER SEWERAGE TREATMENT PLANT = 216.66
 AREA UNDER TOILET = 33.33
 AREA UNDER PARK = 999.72
 AREA UNDER ROADS, OPEN SPACE, PAVEMENT & PARKING = 6068.60

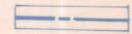
TOTAL OPEN AREA = 8448.04 46.47% AGE

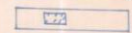
REFERENCE :-

- COLONY BOUNDARY 
- ROAD, PAVEMENT & PARKING 
- EXISTING BUILDING 
- ELECTRIC LINE/POLE 

REVISED LAY-OUT PLAN

SCALE :- 1" = 40'-0"

DRAWING NO. P.A(A) - 4R DATED :- 16-03-06

BEDI CONSULTANTS
P.S. BEDI
 Formerly Senior Town Planner
 Reg. No. 1518 CA
 436, Puda Camp, Jalandhar.
 Mobile: 98161 7002

SIGNATURE OF PROMOTER

SIGNATURE OF ARCHITECT / TOWN PLANNER

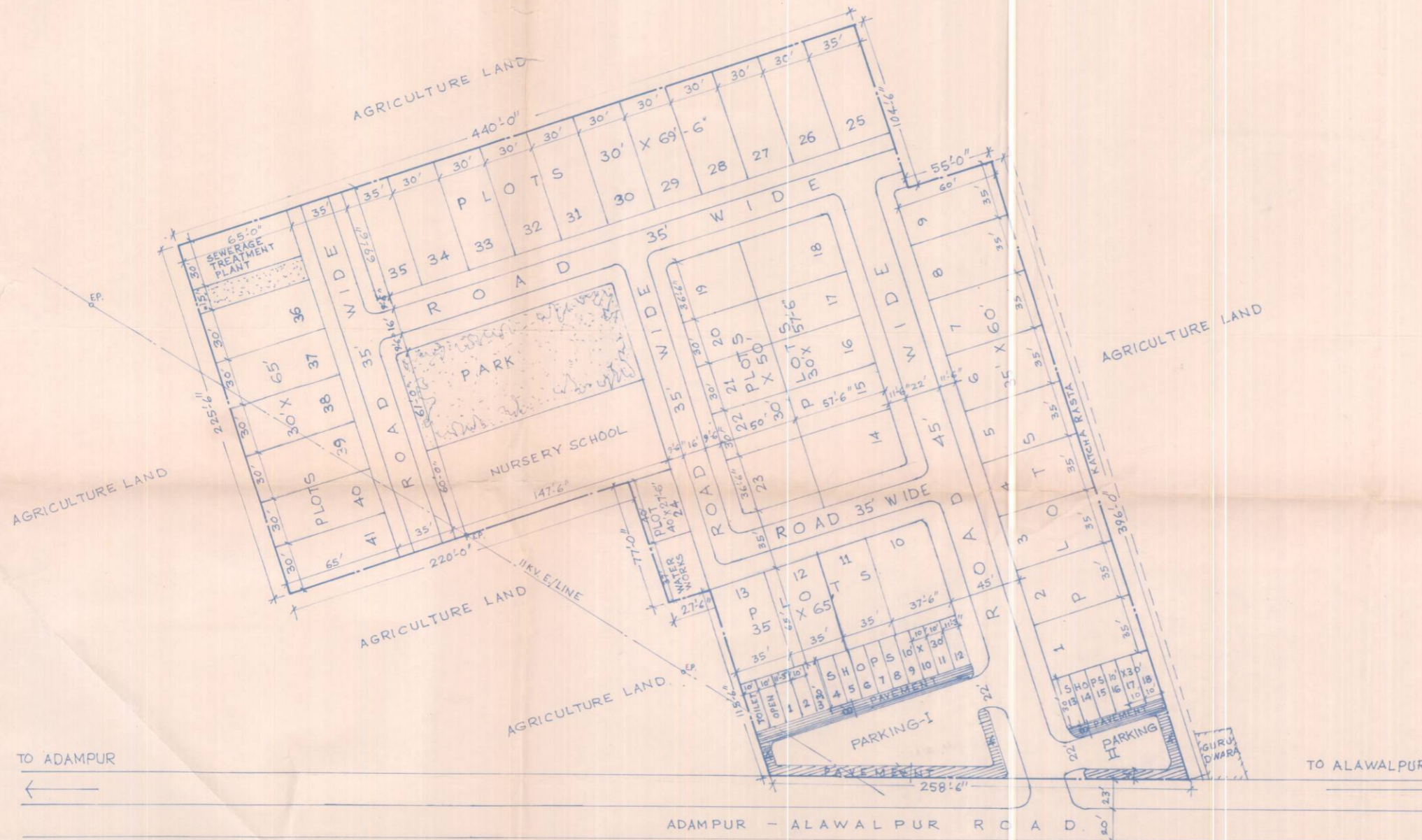

PARKING - I
 TOTAL SHOPS AREA = 408.33 SQ.YDS. OR 341.54 SQ.MTS.
 REQUIRED 341.54 X 1.33 = 454 ECS SAY 5' X 22' = 110 SQ.MTS.
 PROVIDED 134' X 36' = 4824 SQ.FT. = 536 SQ.YDS. OR 448 SQ.MTS.

PARKING - II
 TOTAL SHOPS AREA = 200 SQ.YDS. OR 167.30 SQ.MTS.
 REQUIRED 167.3 X 1.33 = 223 ECS SAY 3' X 22' = 66 SQ.MTS.
 PROVIDED 56' X 26' = 1456 SQ.FT. = 161.77 SQ.YDS. OR 135.32 SQ.MTS.