

LAYOUT PLAN OF THE MOHINDRA ENCLAVE, RESIDENTIAL COLONY, SITUATED AT TARAN TARAN

PROMOTERS:- SH. SATPAL S/O SH. RAM KRISHAN
 REGISTRATION NO. ACA/PUDA/JAL./10946
 DATED:- 23-12-2005

TOTAL AREA OF SCHEME :- 47341.25 sq. yds. 9.78 ACRE
 SCHEME BOUNDARY

DESCRIPTION OF RESIDENTIAL AREA				
S.NO.	PLOT NO.	NO. OF PLOTS	SIZE OF PLOTS	TOTAL AREA
1	1	1	A.P.S	355.55 sq. yds.
2	2-4	3	30'x25'	750.00 sq. yds.
3	5-7	3	27'-6"x75'	229.16 sq. yds.
4	8-12	5	30'x73'-2"	243.86 sq. yds.
5	13	1	32'xA.P.S.	251.00 sq. yds.
6	14-23	10	27'-0"x60'	1800.00 sq. yds.
7	24-25	2	33'-4"x92'	681.40 sq. yds.
8	26	1	35'-3"x92'	360.33 sq. yds.
9	27	1	41'-6"x101'-11"	469.96 sq. yds.
10	28	1	41'-6" A.P.S.	401.94 sq. yds.
11	29-43	15	30'x60'	200.00 sq. yds.
12	44-45	2	30'-0"x65'	433.32 sq. yds.
13	46	1	30'-6"x75'	254.16 sq. yds.
14	47-56	10	30'-7"x75'	2548.30 sq. yds.
15	57	1	30'-6"x75'	254.16 sq. yds.
16	58	1	30'x80'	266.66 sq. yds.
17	59-60	2	28'-8.5"x80'	510.22 sq. yds.
18	61-62	2	30'x80'	533.32 sq. yds.
19	63-64	2	30'x75'	500.00 sq. yds.
20	65	1	28'-9"x60'	191.67 sq. yds.
21	66-67	2	30'x60'	400.00 sq. yds.
22	68	1	31'-0"x60'-9"	209.25 sq. yds.
23	69-75	7	30'-0"x60'-9"	1417.50 sq. yds.
24	76	1	30'-9"x60'-9"	205.00 sq. yds.
25	77-80	4	30'-0"x60'-0"	800.00 sq. yds.
26	81	1	33'-9"x60'	225.00 sq. yds.
27	82-85	4	30'x75'	1000.00 sq. yds.
28	86	1	33'-9"x60'	225.00 sq. yds.
29	87-90	4	30'-0"x60'	800.00 sq. yds.
30	91	1	30'-9"x60'	205.00 sq. yds.
31	92-93	2	37'-6"x75'	625.00 sq. yds.
32	94	1	28'-9"x75'	239.58 sq. yds.
33	95-97	3	30'x75'	750.00 sq. yds.
34	98	1	30'-9"x75'	256.25 sq. yds.
35	99-110	12	30'x60'-6"	2419.92 sq. yds.
36	111	1	A.P.S.	338.88 sq. yds.
37	112-113	2	33'x66'	484.00 sq. yds.
TOTAL				26069.03 sq. yds.

DESCRIPTION OF COMMERCIAL AREA				
S.NO.	S.C.F NO.	NO. OF PLOTS	SIZE OF PLOTS	TOTAL AREA
1	1	1	26'-6"x66'	165.00 sq. yds.
2	2-17	16	16'-6"x66'	121.00 sq. yds.
3	18	18	A.P.S	120.00 sq. yds.
TOTAL				2250.33 sq. yds.

TOTAL AREA OF SCHEME :- 47341.25 sq. yds. 9.78 ACRE		
SALEABLE AREA		
AREA IN SQ. YDS.	%AGE	
1) AREA UNDER PLOTS :- 26069.03 sq. yds.	55.06%	
2) AREA UNDER S.C.F. :- 2250.33 sq. yds.	4.75%	
NON SALEABLE AREA 28319.36 sq. yds. 59.91%		
3) AREA UNDER SCHOOL :- 1010.64 sq. yds.	2.13%	
4) PARK & GREEN SPACE :- 2472.10 sq. yds.	5.24%	
5) ROADS, PAYMENTS & PARKING :- 15141.09 sq. yds.	31.99%	
6) SEWERAGE TREATMENT PLANT :- 261.95 sq. yds.	0.55%	
7) WATER WORKS :- 136.11 sq. yds.	0.28%	
TOTAL SALEABLE AREA (1&2) = 28319.36 sq.yds.	59.81%	
TOTAL NON SALEABLE AREA (3-7) = 19021.89 sq.yds.	40.19%	
AREA UNDER KHAL & REVENUE RASTA:- 268.88 SQ. YDS.		

NOTE :- AREA UNDER KHAL & REVENUE RASTA IS EXCLUDED FROM THE COLONY.
 DRAWING NO. MA/01 DATED :- 29-07-2006

NORTH SCALE :- 1" = 80' A.T.P. No. 1998-23

Competent Authority (Under Pof. no. 1995) Cum Senior Town Planner AMRITSAR

OWNER'S SIGNATURE: SH. SATPAL
 TOWN PLANNER SIGNATURE: CIVIL ENGINEER A.I.T.P., M.A., L.L.B. CORPORATE MEMBER I.I.T.A. Superintending Engineer (H.O.)

AHLUWALIA & ASSOCIATES ARCHITECTURAL & STRUCTURAL CONSULTANTS 16-A, ROSE AVENUE, MAQBOOL ROAD, AMRITSAR. PH. NO. 2563339, 98140-50709.

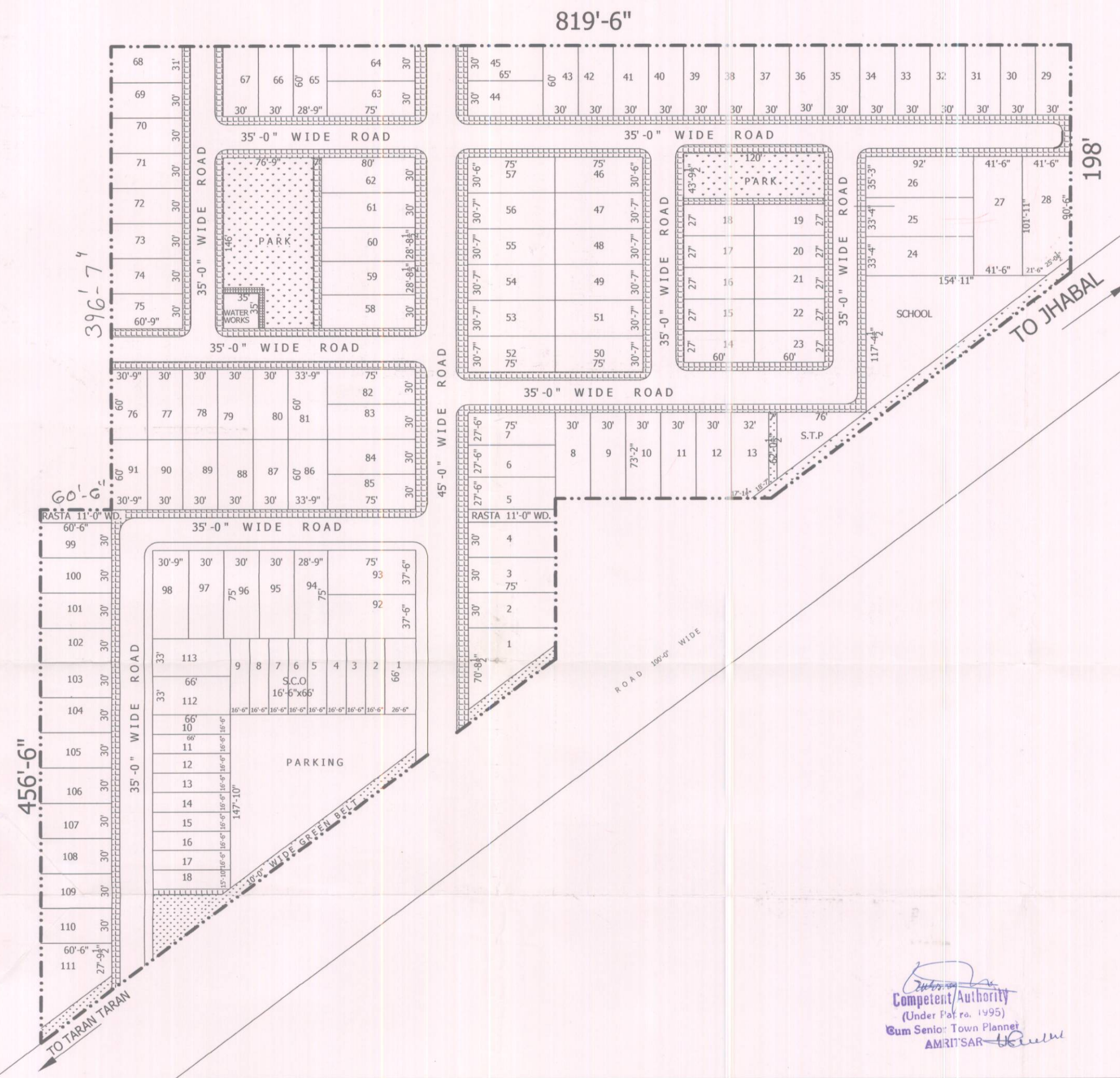

396'-7"

60'-6"

456'-6"

Competent Authority (Under Pof. no. 1995) Cum Senior Town Planner AMRITSAR