

PROPOSED PLANS OF
 "GEETA COLONY"
 RESIDENTIAL COLONY AT
 VILLAGE BASTI SHEIKH
 TEH. & DIST. JALANDHAR

PROMOTERS ;
 HIGHTECH ASSOCIATES
 ST. SOLDIER TOWER, 3-4
 VIKAS PURI COMMUNITY CENTRE,
 NEW DELHI.

- SCHEME BOUNDARY
- TOTAL SCHEME AREA = 23.73 Acres or 11,854,985 Sq. Mts
- AREA UNDER RESIDENTIAL PLOTS :

SNO	AREA UNDER	NO. OF PLOTS	TOTAL AREA IN SQ. MTS	AREA UNDER RESIDENTIAL PLOTS IN SQ. MTS
5	AREA UNDER SCHOOL CENTRE	1	4260.00	0.89
6	AREA UNDER HEALTH CENTRE	1	1651.25	0.337
8	AREA UNDER PARKS:			
	PARK 1 -	1200.00		
	PARK 2 -	1560.00	2760.00	0.57
9	AREA UNDER ROADS, PARKINGS PAVEMENTS		35682.64	7.373

NOTE: PLOT NO. 211 TO 218, 224, 224A, 225 ARE DELETED.

SNO	PLOT NO.	NO. OF PLOTS	AREA IN SQ. MTS	TOTAL AREA IN SQ. MTS	AREA UNDER RESIDENTIAL PLOTS IN SQ. MTS
1	44 to 52	9	250.89	2259.97	
2	53 to 62	10	250.00	2479.00	
3	63 to 72	10	161.11	1511.11	
4	73 to 82	10	241.61	2316.10	
5	83 to 107	25	216.66	3083.24	
6	108 to 132	25	325.00	2175.00	
7	133 to 157	25	375.00	375.00	
8	158 to 182	25	425.00	425.00	
9	183 to 207	25	200.00	6000.00	
10	208 to 232	25	213.33	213.33	
11	233 to 257	25	350.00	1400.00	
12	258 to 282	25	300.00	3000.00	
13	283 to 307	25	275.00	3500.00	
14	308 to 332	25	357.58	357.58	
15	333 to 357	25	290.00	4800.00	
16	358 to 382	25	183.33	735.32	
17	383 to 407	25	173.61	173.61	
18	408 to 432	25	186.11	186.11	
19	433 to 457	25	133.33	2133.23	
20	458 to 482	25	220.00	440.00	
21	483 to 507	25	241.66	483.32	
22	508 to 532	25	251.00	1047.00	
TOTAL PLOTS			249	66252.7	
AREA UNDER PLOTS			17 x 119.16	2025.75	
15 x 75.50			1132.50		
TOTAL SALEABLE AREA			6805.25	5.75%	
TOTAL SALEABLE AREA AS % OF TOTAL AREA			5.75%		
OPEN AREA AS % OF TOTAL AREA			40.0%		

LAYOUT CUM DEMARCATION PLAN
 ! SCALE : 1/18" = 10'-0", 1" = 80'-0"

OWNER
 N 
 ARCHITECT
 DATE: 14-10-1998
 Dwg. No.: HTA-7/4

DHAM CONSULTANTS
 ARCHITECTS, PLANNERS, INTERIOR DESIGNERS
 STRUCTURAL ENGINEERS & LAND SCAPE DESIGNERS.
 G/T, 16-D CHANDIGARH PH. 771525
 STUDIO ARCHITECTURE
 SURYA SHOPPING ARCADE
 NATIONAL ROAD LUKHANA. PH. 401935

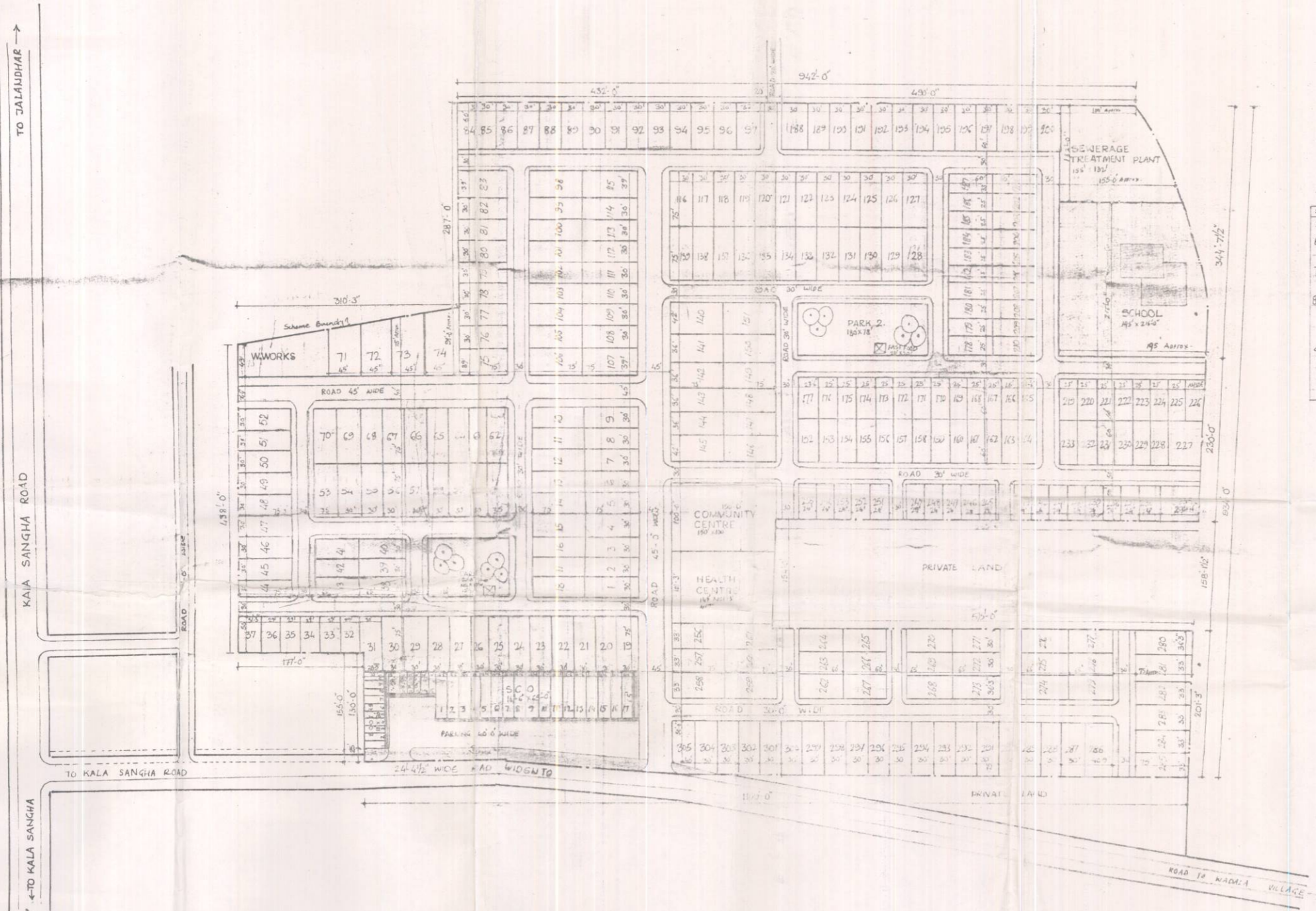

100A

767