

**CENTRAL TOWN  
EXT. AT KAPURTHAL**

PROMOTER M/S CHOPRA LAND DELVOLPERS THROUGH  
S. HARKAMAL. PREET SINGH S/O S. SUKHWINDER SINGH  
(PARTNER)

TOTAL AREA OF SCHEME IS = 18513.00 SQ. YDS. = 3.82 ACR.

**DESCRIPTION OF PLOTS**

S .NO.	PLOTS NO	NO. OF PLOTS	SIZE	AREA OF EACH PLOTS IN SQ YDS.	TOTAL AREA OF PLOTS IN SQ YDS.
1	1-13	13	40'-0"X60'-0"	266.66	3466.66
2	14	1	-	289.69	289.69
3	15-26	12	31'-0"X60'-0"	206.00	2479.99
4	27-31,32-35,38-47	19	30'-0"X60'-0"	200.00	3800.00
5	36	1	-	178.51	178.51
6	37	1	-	170.36	170.36
<b>TOTAL PLOTS</b>		<b>47</b>	<b>56.09%</b>		<b>10385.21</b>

*[Signature]*  
Deputy District Town Planner  
Kapurthala  
(Competent Authority  
Under P&R Act, 1992)

**AREA UNDER COMMERCIAL**

1	1-5	5	10'-11"X25'-0"	30.30	151.52
<b>TOTAL SHOP=5</b>					<b>151.52 SQR.YDS. OR .81%</b>

TOTAL SALEABLE AREA UNDER  
RESIDENTIAL AND COMMERCIAL PLOTS IS = 10536.73 SQR.YDS. 56.91%  
TOTAL AREA UNDER PARK IS = 1. 150.63 SQR. YDS. TOTAL AREA O.H.S.R = 20137 (1%)

2. 105.67 SQR. YDS.
  3. 185.31 SQR. YDS.
  4. 356.38 SQR. YDS.
  5. 336.69 SQR. YDS.
  6. 79.95 SQR. YDS.
  7. 167.97 SQR. YD
- TOTAL = 1382.6 SQR. YDS. 7.5%  
AREA UNDER ROADS & PAVEMENTS = 6392.3 SQ YDS (34.52%)

**TITLE: LAYOUT PLAN**

SCALE: 1"=80'

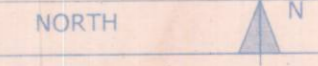

PROMOTER

DRG. NO. — 46/R/CPAD/PTA

DATE



**CITY PLANNER AND  
ARCHITECTURAL DESIGNERS  
DHAK BAZAR PATIALA**

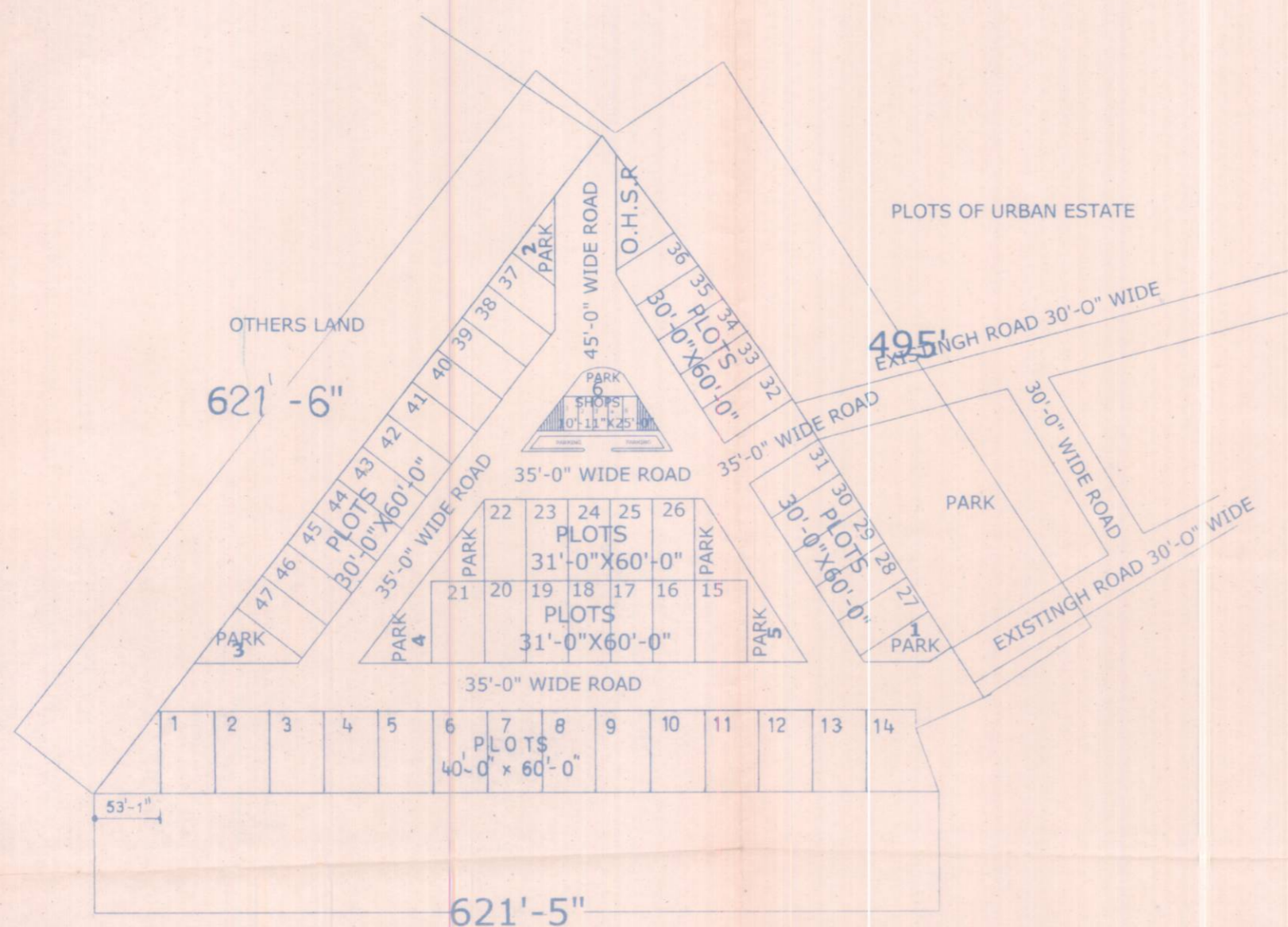

- NOTE :-
- (1) A SCHOOL SITE ALREADY PROPOSED IN CENTRAL TOWN AND A SCHOOL NAMED OLIVER PUBLIC SCHOOL ALREADY EXISTING AT A DISTANCE OF 100 MTR
  - (2) ST.P SITE ALREADY PROPOSED IN CENTRAL TOWN ADJOINING SCHEME